

# GS-PA19

## APPLE CABIN



12-2  
16A  
0358



Technology Group Co., Ltd.

YUEHAI TRADING

# PLANE GRAPH



## Size

Before expansion:  
5800x2250x2450mm

After expansion:  
5800x4175x2450mm

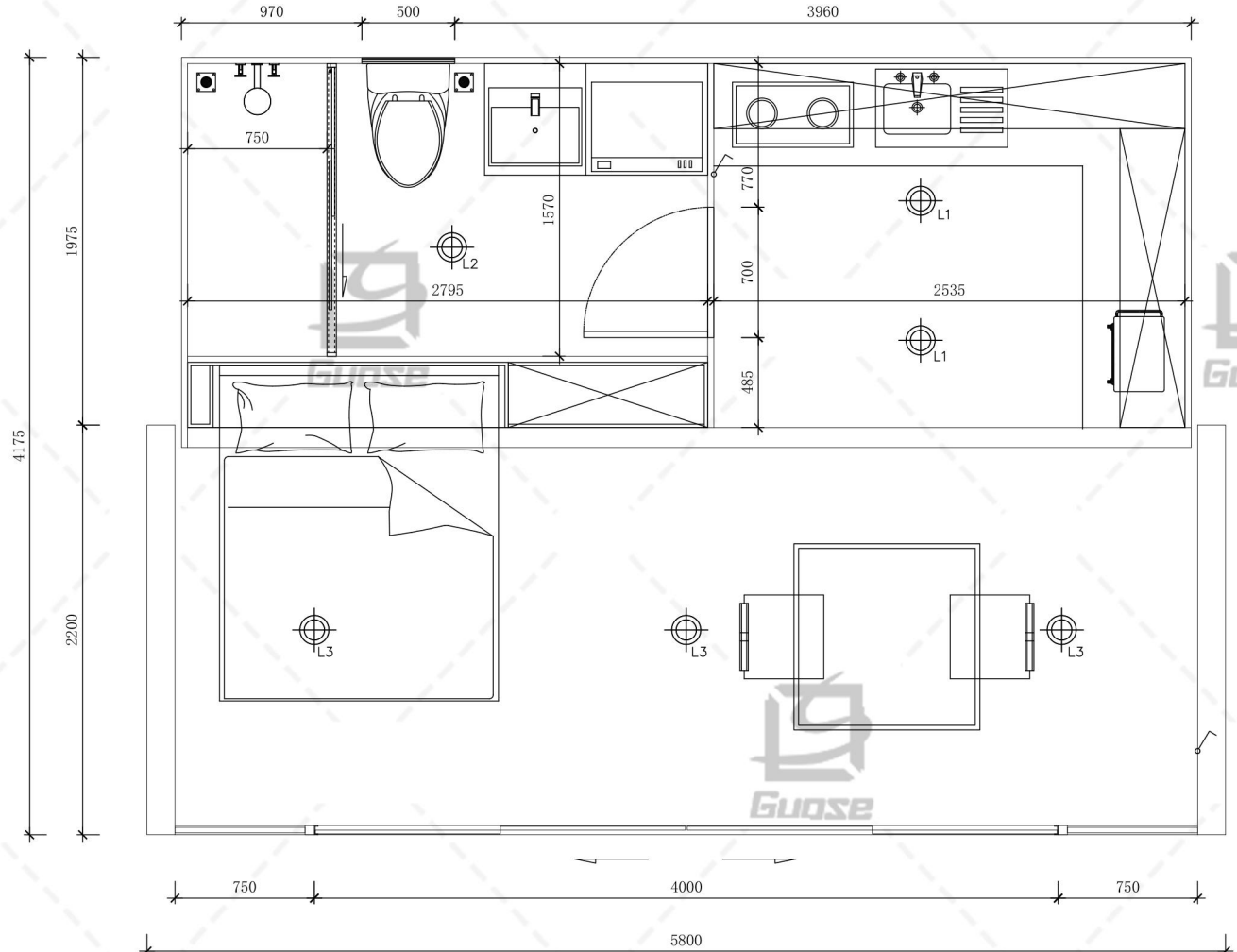



REAL PICTURE



# THREE VIEWS

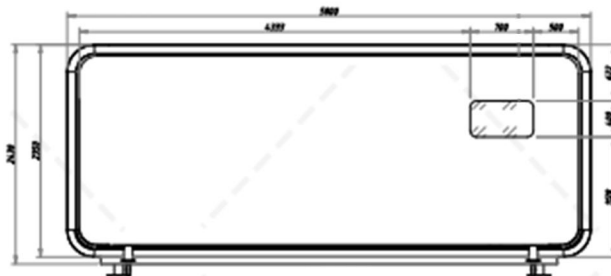

Dorsal view

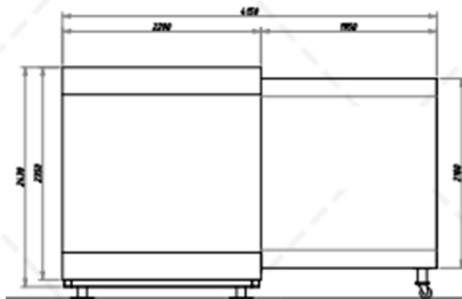

Right view

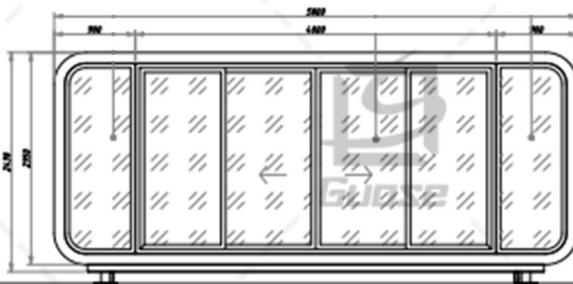

Fron view

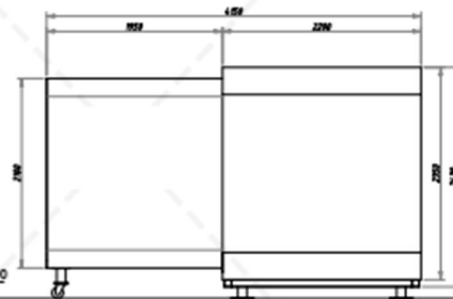

Left view

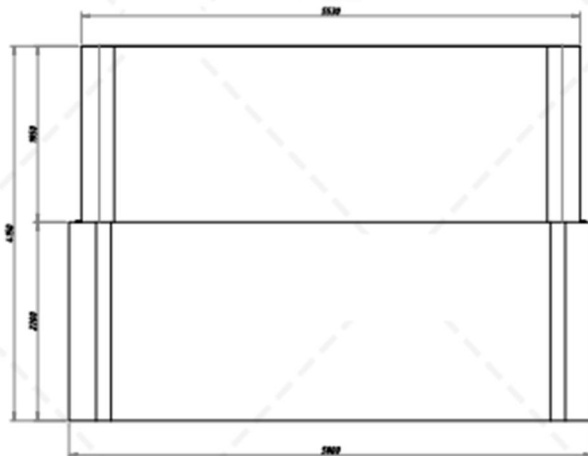

Top view



# APPEARANCE MATERIAL



5+9+5 tempered insulating glass

Aluminum alloy glass sliding door

FRB board+XPS board

Trailer rack



Hand pedal

Power interface



Vent

Power interface





# INTERNAL MATERIAL

Guose

Guose

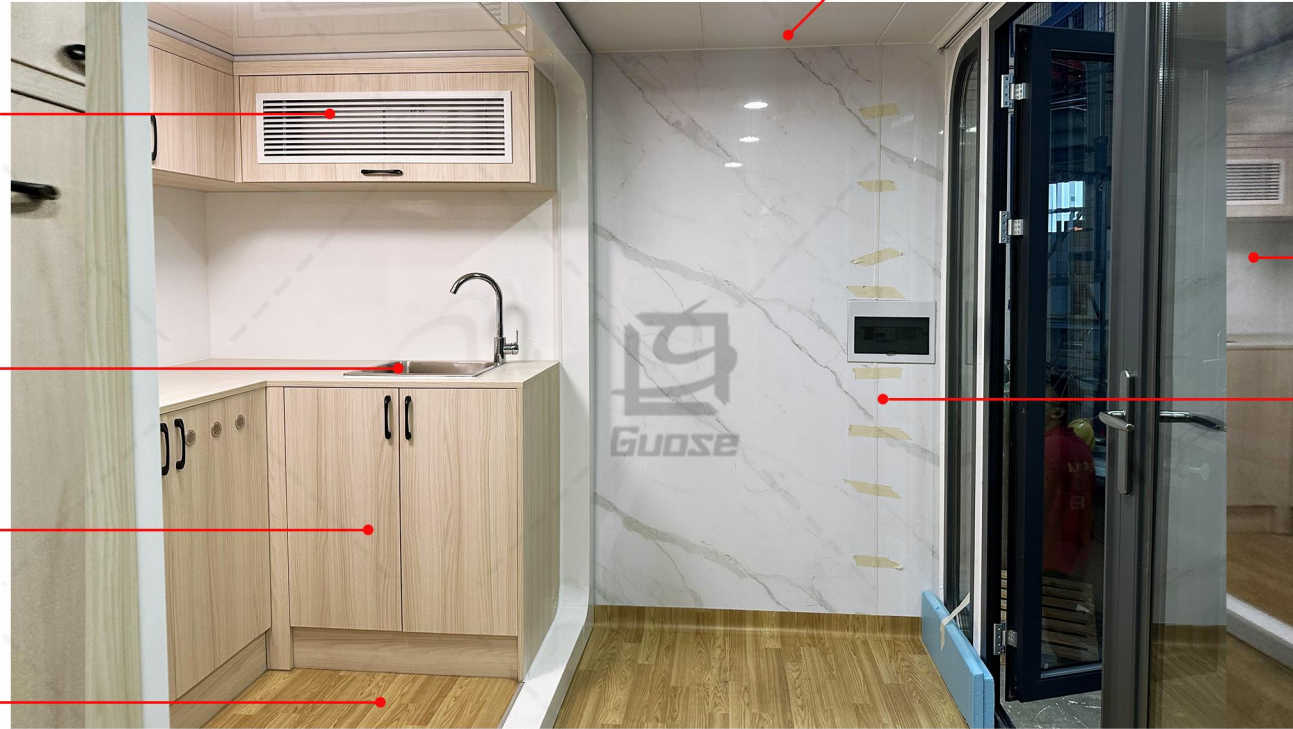

Air conditioner

FRB board+XPS board

Wash basin

5+9+5 tempered insulating glass

Cabinet

FRB board+XPS board

Water-based floor glue + floor leather



Straight tilting bed



Induction cooker



Kitchen hood



Wash basin



Toilet

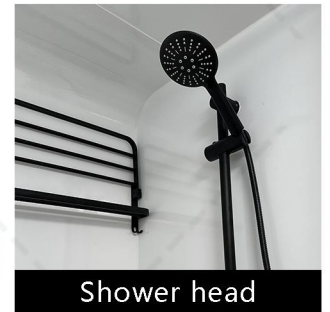

Shower head



# SHIPPING DRAWING

